

Doorbell Camera + Chime-box QuickStart Guide

CSP-DB6I (Doorbell Camera) / CSP-DS21 (Chime-box)

Please note that a DMSS account is required for the Doorbell camera and Chimes additional settings.

Please make sure you have the DMSS App installed on your phone.

Scan the appropriate QR Code below with your Device for a direct link to the app.

Download the DMSS App for Android



Download the DMSS App for iOS.



Index.

[Setting up your DMSS Account.....](#) pg. 2

[Connecting your CSP-DS21 Chime box.....](#) pg. 3

[Connecting your CSP-DB6I Doorbell Camera.....](#) pg. 4

[Linking your CSP-DB6I Doorbell and CSP-DS21 Chime box.....](#) pg. 6

Setting up your DMSS Account

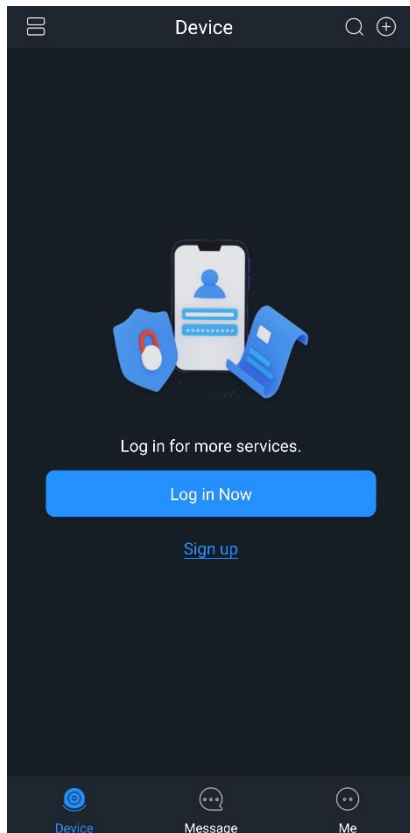

Once you have downloaded the DMSS App go to the Home Page on the app and click on the Sign-Up button to create an account.

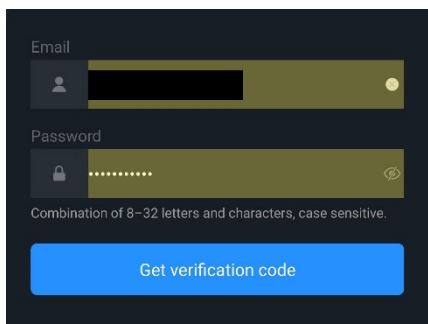

Enter your **Email and Password** and it will prompt you to send a **Verification Code**. If the email is valid, it will send you the code to your email address and you can type the code into the app to verify your account.

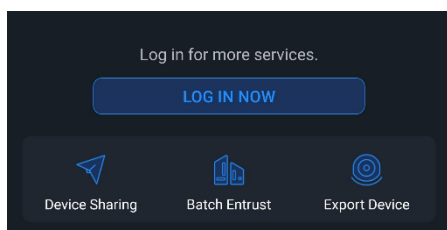

Once the account is verified you can Login from the **Me > Login** page on the app and at the top click **LOG IN NOW**

Connecting your CSP-DS21 Chime box

To connect your CSP-DS21 Chime box insert the outlet adapter into the box and plug it into a wall outlet. **Do not throw away the box.** Once plugged in, the device will wait approximately one minute for the chime box to power on and you should hear the chime-box say from its speaker that the **Hot Spot is Ready to Connect.**

Once the chime box says the hotspot is ready, open the app and proceed to the **Home Page** of DMSS. On the **top right** of the screen there will be a + Icon, Click the + Icon and hit **Scan** and point the phone's camera at the QR code on the Box the chime box came in. The QR code will be on the Side of the box.

It will attempt to search for the local hotspot of the chime box and ask you if you want to connect to its network. Allow it to connect and the device will prompt you to select a network you want to join the device to.

The CSP-DS21 only supports 2.4Ghz networks.

If the device fails to find and connect to the hotspot:

1. Click on the Set Button
2. Manually Search for the hotspot and connect.
3. Return to the app and try again.
4. If the process continues to fail hold the reset button on the side of the Chime-box for 30 seconds until the device Hard Resets and try the process over.

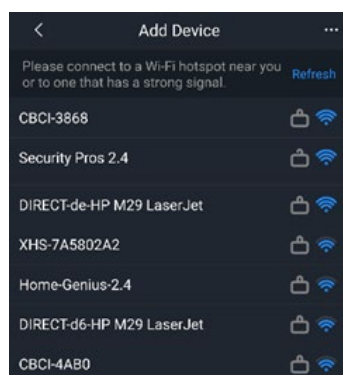

Once your phone or tablet is connected to the hotspot, the device will ask you what network you want to connect it to, you must **connect to your Wi-Fi**. Select **your personal Wi-Fi** from the list and enter in **your Wi-Fi password**.

After selecting your Wi-Fi and the device connects. It will ask you to **enter a username and password** for your CSP-DS21 chime. Enter your password twice

and input your email address at the bottom if it did not autofill, then hit **Next** and that will finish the setup process for the CSP-DS21. Your device will be ready to connect.

Connecting your CSP-DB6I Doorbell Camera

If you are using the CSP-DB6I Doorbell Camera, you first need to make sure the camera is powering on. When plugging it in with the provided power supply watch the light on the front of the camera and wait approximately one minute for the camera to power on. You should hear the camera say from its speaker that the **Hot Spot is Ready to Connect**.



Once the hot spot is ready to connect, open the app and proceed to the **Home Page** of DMSS. On the **top right** of the screen there will be a + Icon, Click the + Icon and hit **Scan** and point the phone's camera at the QR code on the back of the doorbell camera. The QR code will be at the top of the back side on a sticker.

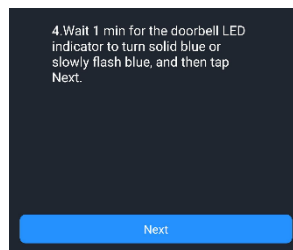

Once scan the QR code a prompt will appear on the screen asking you to add the device. Hit **Next**, this will take you to a page asking you to connect to the hotspot of the camera.

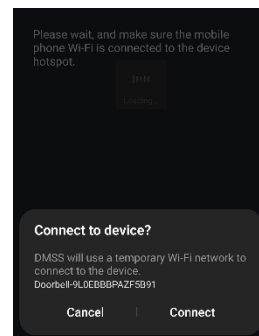

It will attempt to search for the local hotspot of the camera and ask you if you want to connect to its network. Allow it to connect and the device will prompt you to select a network you want to join the device to.

After connecting to the doorbell's hot spot, it will ask what network you want to connect it to, **connect it to your Wi-Fi**. Select **your personal Wi-Fi** from the list and enter in your **Wi-Fi password**.

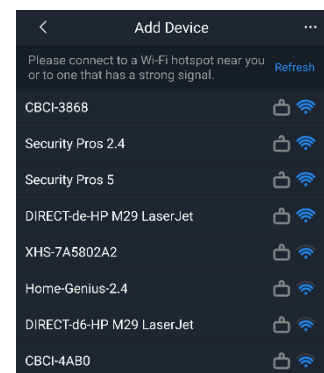

If the device fails to find and connect to the hotspot:

1. Click on the Set Button
2. Manually Search for the hotspot and connect.
3. Return to the app and try again.
4. If the process continues to fail open the back panel on the camera labeled Reset / Micro-SD. Push in the reset button with a paper clip for 30 seconds until the device Hard Resets.

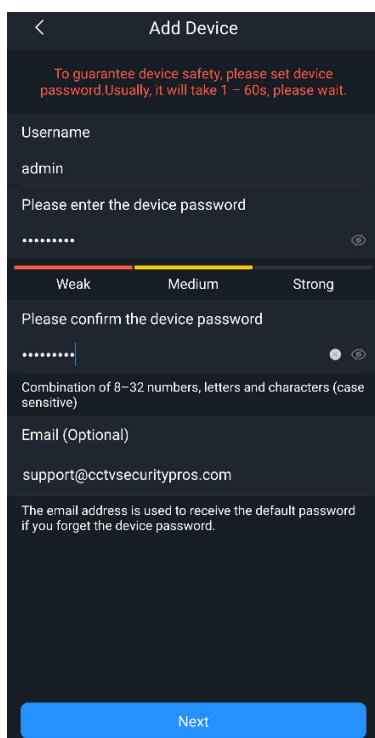

Once your phone or tablet is connected to the hotspot, the device will ask you to enter a username and password. Enter your password twice and input your email address at the bottom if it did not autofill, then hit **Next**.



It will then ask you if you have a Chime you want to set up. If you have configured the CSP-DS21 Chime box to the app already it will show up here. If you do not have one you can skip this step by clicking the **Skip button in the top right**. After that you will be greeted with a live view of the camera.

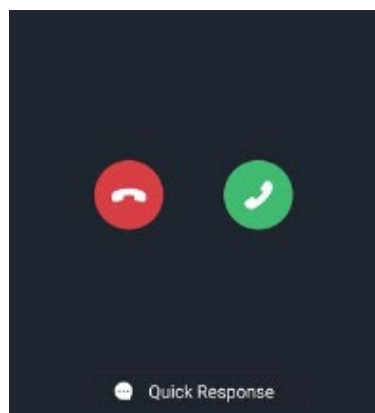

If you push on the doorbell button on the doorbell camera, the app will begin a call with you in which you can accept, decline, or leave a message to the person on the other side.

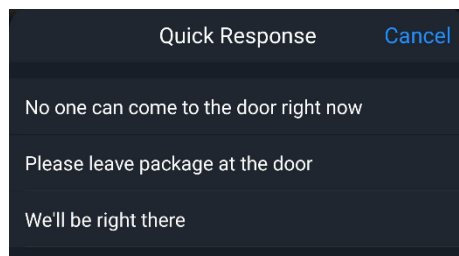

*The quick response page comes with 3 built in responses and more can be added from the **device details** page in the form of a voice recording.*

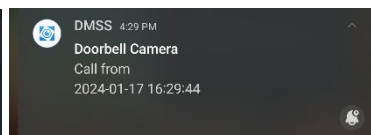
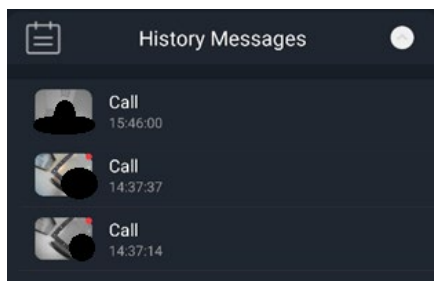

Calls will send you a notification from the app when they happen.

If you miss a call, you can view a recording of the person who rang your doorbell by going to Call History at the bottom of the Live View.

The **Device Details** page can be accessed from the live view of the camera by clicking on the gear icon in the **top right corner of the live feed** or from the Home Page by clicking the **three dots** and going to **Device Details**.

Linking your CSP-DB6I Doorbell and CSP-DS21 Chime box

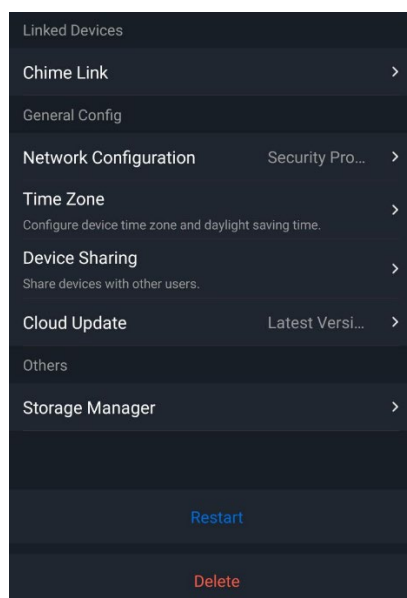

If you are adding the CSP-DS21 Chime-box after installing the CSP-DB6I Doorbell camera, you can link the Chime-box from the **Device Details** page under Chime-Link

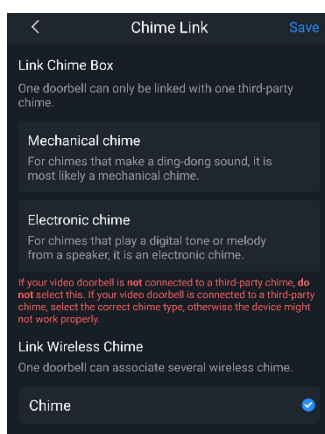

Select the Chime in the list at the bottom and click **Save** in the top right to add the Chime to your Doorbell.

Once saved you can press on the Doorbell Button on the CSP-DB6I, and it will play a sound from the Chime-box.

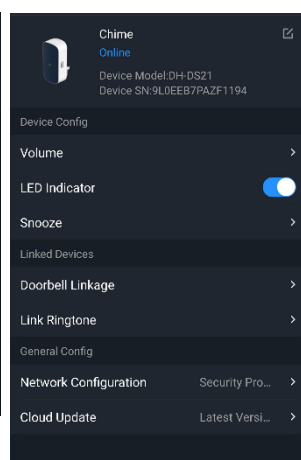
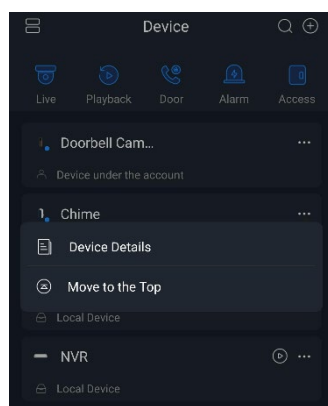

Both the Volume of the chime box and the sounds can be customized from the Device Details page as well from the Link Ringtone page.

You can pick between 11 different sounds in the settings.