

Remote Viewing on Mobile Devices

To access your recorder remotely you must first connect it to your modem or router using an Ethernet cable and power on the recorder.

Go to **Main Menu->Setting->Network-TCP/IP** and Enable "**DHCP**" Inside of the Network settings and Save.

*Some models require you to click "**Edit or Modify**" next to NIC1 to find the **DHCP** option to enable.

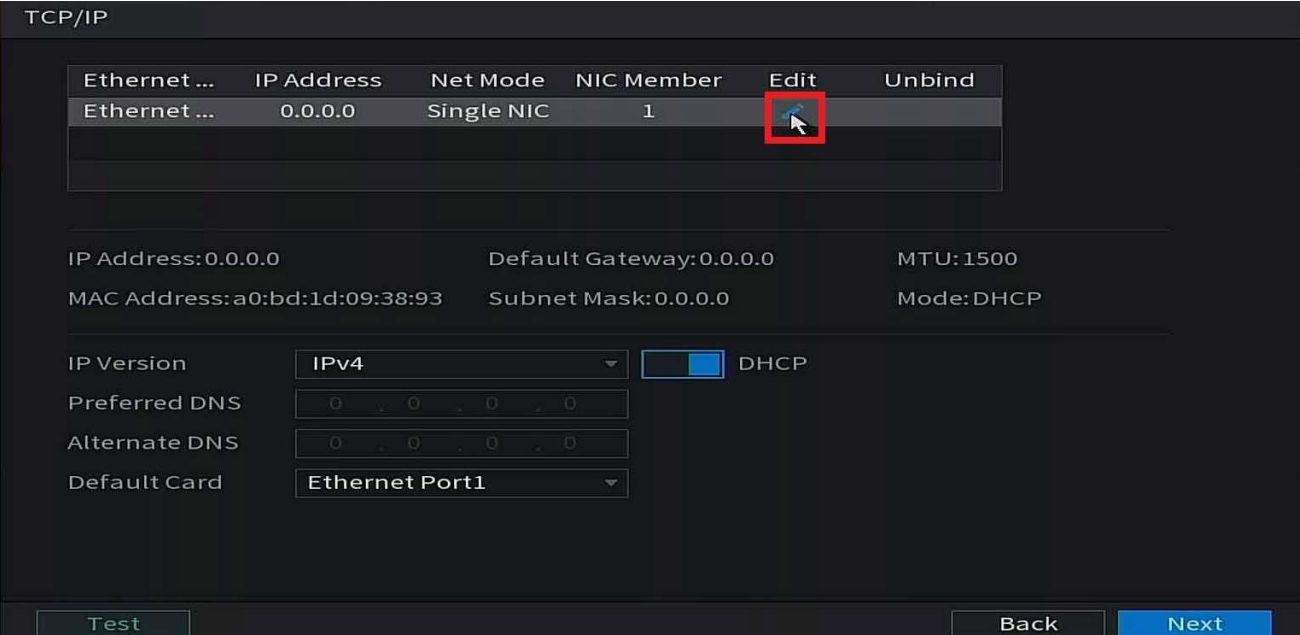

TCP/IP

Ethernet ...	IP Address	Net Mode	NIC Member	Edit	Unbind
Ethernet ...	0.0.0.0	Single NIC	1		

IP Address:0.0.0.0 Default Gateway:0.0.0.0 MTU:1500
MAC Address:a0:bd:1d:09:38:93 Subnet Mask:0.0.0.0 Mode:DHCP

IP Version: IPv4 DHCP
Preferred DNS: 0 . 0 . 0 . 0
Alternate DNS: 0 . 0 . 0 . 0
Default Card: Ethernet Port1

Test Back Next

Make sure DHCP is enabled. Click OK at the bottom.

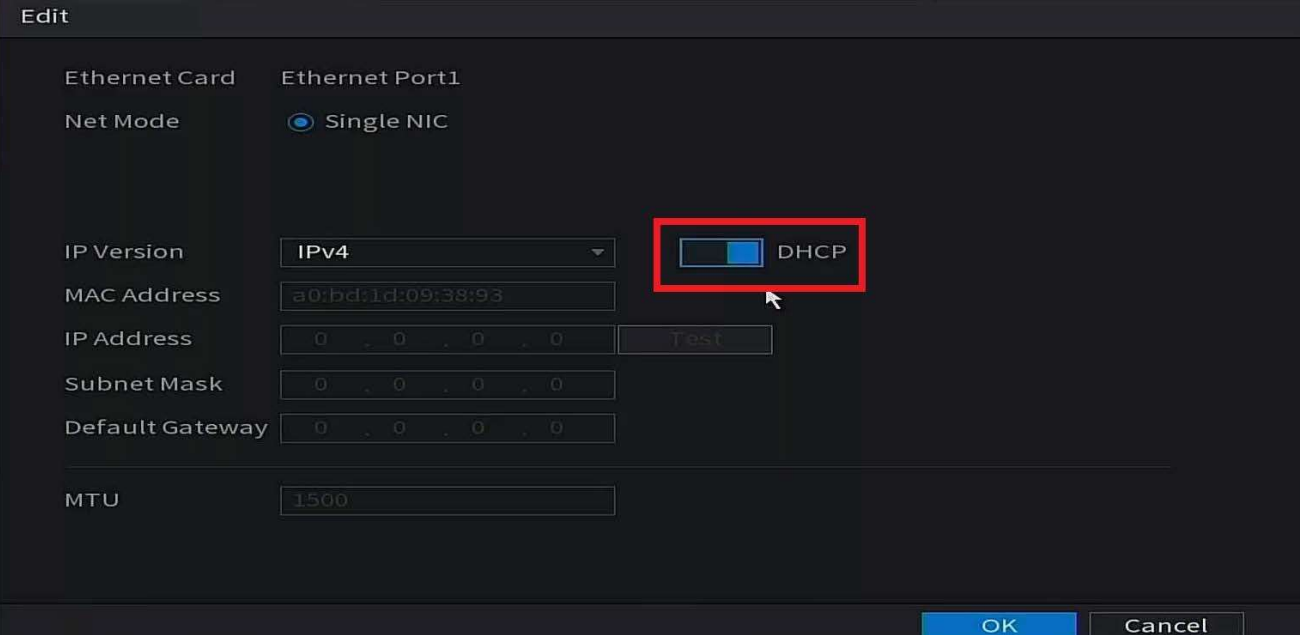

Edit

Ethernet Card: Ethernet Port1
Net Mode: Single NIC

IP Version: IPv4 DHCP
MAC Address: a0:bd:1d:09:38:93
IP Address: 0 . 0 . 0 . 0 Test
Subnet Mask: 0 . 0 . 0 . 0
Default Gateway: 0 . 0 . 0 . 0

MTU: 1500

OK Cancel

Be sure to Save / Apply these settings before moving on.

Navigate to the **Main Menu-> Setting -> Network -> P2P** (sometimes called Easy4IP)

Enable P2P at the top of the menu and select **Apply**

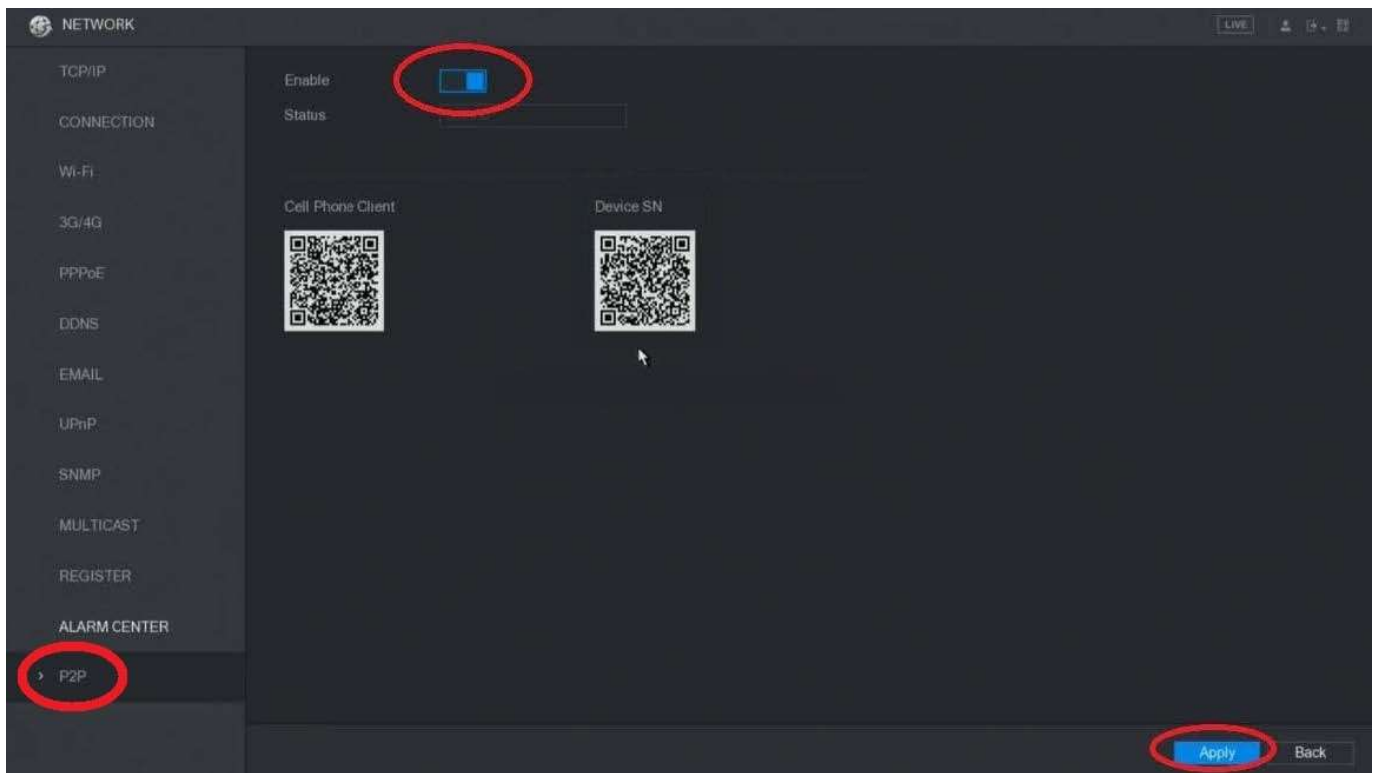

Your P2P status will show "**Online**" now. If P2P shows "Online" you can proceed to the next steps in this guide.

If you are still getting an "Offline" status

- 1.) Make sure your DVR/NVR has an Ethernet connection to a router/modem
- 2.) Make sure **DHCP** is enabled inside of **TCP/IP** as show earlier in this guide.

You may want to leave this menu up since we will be using the **Device SN QR code** in the next few steps.

Downloading DMSS on your Mobile Device

You must use the mobile application **DMSS** on your iOS or Android device. This can be found in the iOS App Store or the Google Play Store. Search for **DMSS** and download our free application.



Alternatively, you can scan the QR code for your device and it will take you to the app store.

IPHONE/IPAD



ANDROID PHONE/TABLET



Launch DMSS once it has been downloaded from the App Store or Play Store. Select your Region / Language. Once you are on the Device section of DMSS. Click on the + **Icon** at the top right corner. Select **SN/Scan**. Scan the **Device SN QR code** found on the right-hand side of your P2P menu on your DVR or NVR. This screen may still be up on your system if you are following this guide. Once the code has been scanned you will see the **Device SN** appear on your device. Click **Next**.

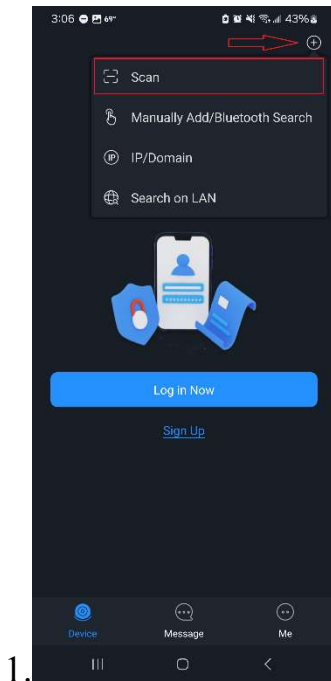

1.

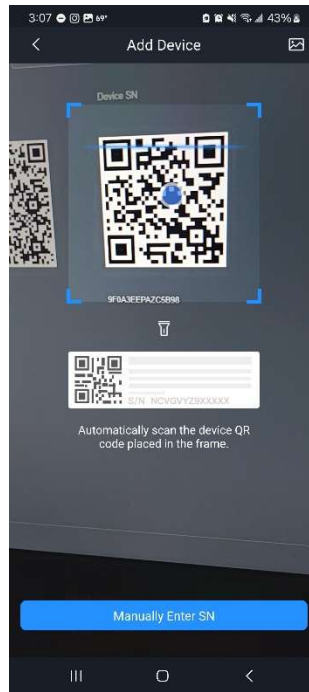

2.

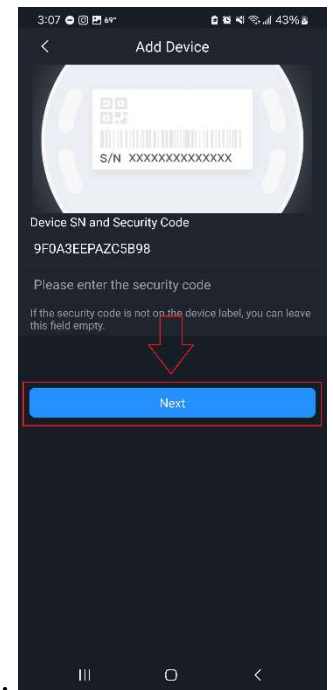

3.

Select **DVR/XVR** or **NVR**. Enter a **Device Name**, your **username (admin)** and the **Password** you use to log into your DVR or NVR with. Click **Save**. The Live View will appear once the device has been saved.

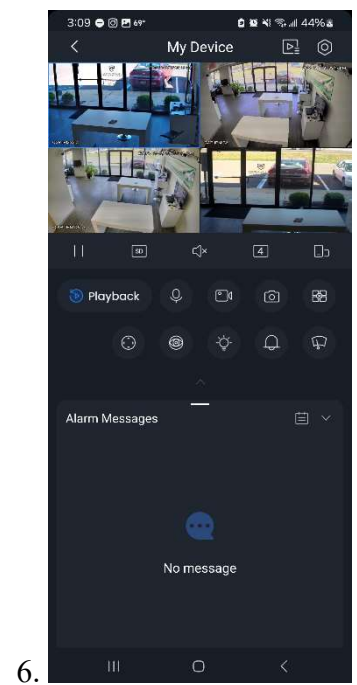
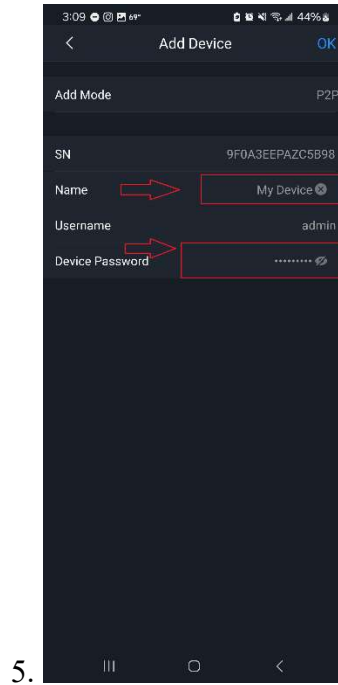
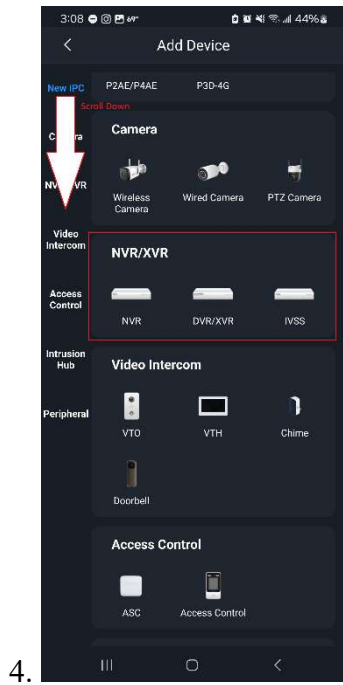

Note: If your P2P status shows "**Offline**" your cameras will not connect. Please make sure your system is connected to a router or modem with Internet service with an Ethernet cable and that DHCP is enabled.